

Flange EM-A/B/C

EM-A/B/C chuck adapters

Mandrino espansibile con pinze autostaffanti
Clamping mandrel with pull-down sleeves

TIPO - Type EM-A

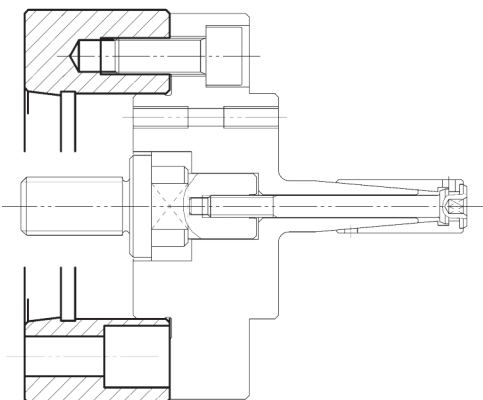

TIPO - Type EM-B

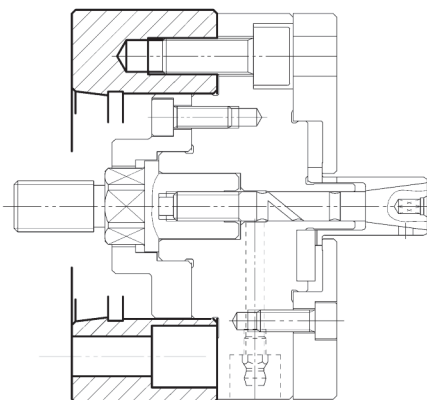

TIPO - Type EM-C

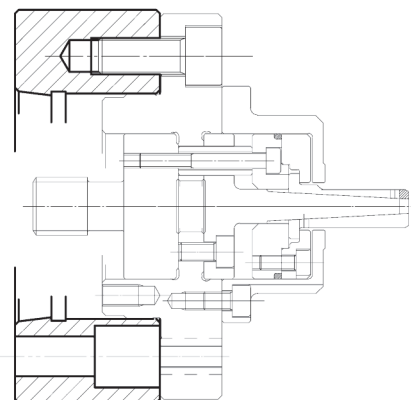

Soggetto a cambiamenti tecnici - Subject to technical changes

Flangia di attacco Adapter	Tipo - Type EM-A	Tipo - Type EM-B	Tipo - Type EM-C
Flangia ISO-A4 D62 espans EM - Adapter 24140100	1-2-3-4-5-6	0-1-2-3	1-2-3
Flangia ISO-A5 D62 espans EM - Adapter 24150100			
Flangia ISO-A6 D62 espans EM - Adapter 24160100			
Flangia ISO-A8 D62 espans EM - Adapter 24180100	n/d	4	n/d
Flangia ISO-A5 D86 espans EM - Adapter 68634020			
Flangia ISO-A5 D86 espans EM - Adapter 24150400			
Flangia ISO-A6 D86 espans EM - Adapter 24160400	7-8-9-10-11	4	n/d
Flangia ISO-A8 D86 espans EM - Adapter 24180400			
Flangia ISO-A11 D86 espans EM - Adapter 24110400			

- Flangia ISO-A4 D62 espans EM - Adapter 24140100
- Flangia ISO-A5 D62 espans EM - Adapter 24150100
- Flangia ISO-A6 D62 espans EM - Adapter 24160100
- Flangia ISO-A8 D62 espans EM - Adapter 24180100
- Flangia ISO-A5 D86 espans EM - Adapter 68634020
- Flangia ISO-A5 D86 espans EM - Adapter 24150400
- Flangia ISO-A6 D86 espans EM - Adapter 24160400
- Flangia ISO-A8 D86 espans EM - Adapter 24180400
- Flangia ISO-A11 D86 espans EM - Adapter 24110400

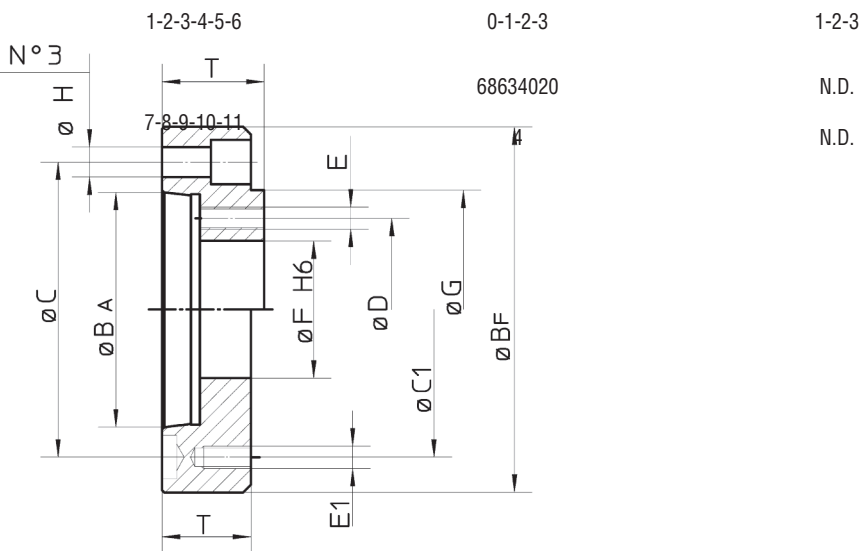

Flangia no. Adapter Id. no.	Naso macch. Spindle nose	BF mm	BA mm	C mm	C1 mm	D mm	E mm	E1 mm	F mm	G mm	H mm	T mm
24140100	A4	108	63.513	82.6	82.6	-	-	3 x M10	62	-	11	40
24150100	A5	127	82.563	104.8	82.6	-	-	3 x M10	62	-	11.5	40
24160100	A6	165	106.375	133.4	-	82.6	3 x M10	-	62	-	13.5	40
24180100	A8	210	139.719	171.4	-	82.6	3 x M10	-	62	120	17	40
24150400	A5	135	82.563	104.8	104.8	-	-	3 x M10	86	-	12	40
24160400	A6	165	106.375	133.4	133.4	104.8	3 x M10	3 x M12	86	-	13.5	40
24180400	A8	210	139.719	171.4	133.4	104.8	3 x M10	3 x M12	86	-	17	40
24110400	A11	280	196.869	235	133.4	104.8	3 x M10	3 x M12	86	-	21	40
68634020	A5	185	82.563	104.8	133.4	104.8	3 x M10	3 x M12	86	-	13.5	64

Flange PEL + distanziali

Air sensing + extended adapters

Flange PEL + distanziali
per mandrini espansibili
Air sensing + extended adapters
for clamping mandrels

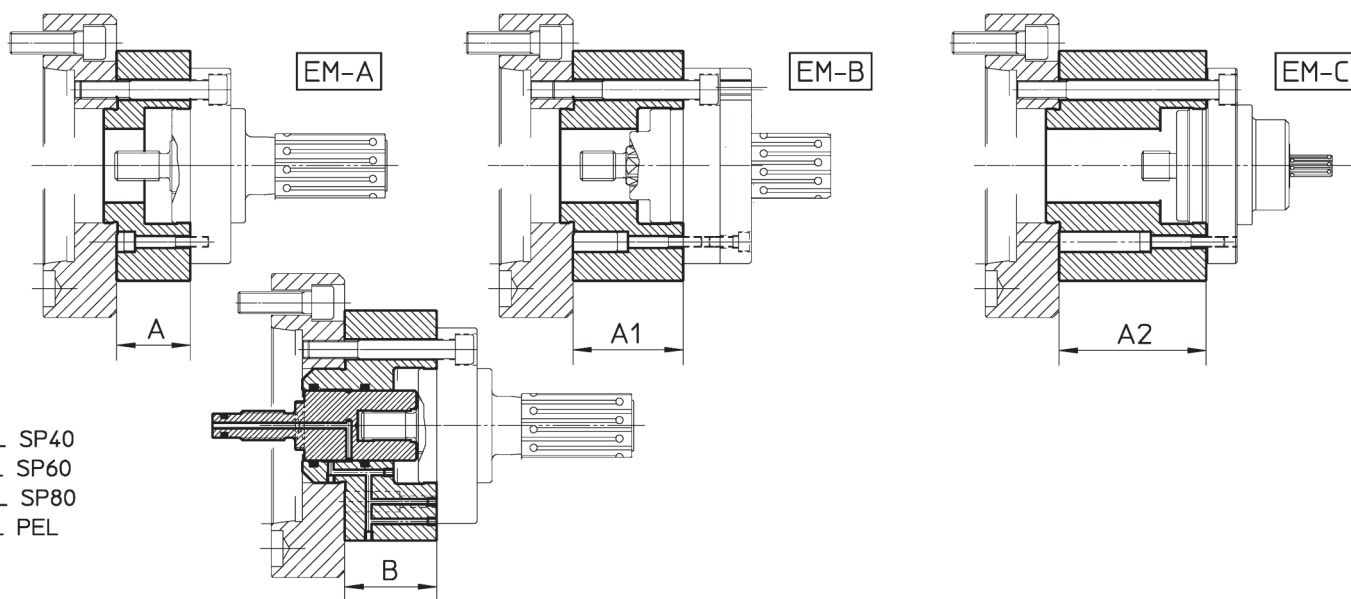

EM-A	EM-B	EM-C	A	A1	A2	B (PEL)	C	D	E	ØF	G
Grandezza/Size											
1÷6	0÷3	1÷3	40	60	80	50	A+B = 90 (PEL) A1+B = 110 (PEL) A2+B = 130 (PEL) A+A = 80 A+A1 = 100 A1+A1 = 120 A2+A1 = 140	30	45	125	27 29
Codice/Code			68610110	68620110	68630110	EM-A 68600110 EM-B 68600120					
7÷11	-	-	40	60	-	55	A+B = 95 (PEL) A1+B = 115 (PEL) A+A = 80 A+A1 = 100 A1+A1 = 120	30	45	130	22
Codice/Code			68610710	68620710	-	68600710					
-	4	-	40	60	-	60	A+B = 100 (PEL) A1+B = 120 (PEL) A+A = 80 A+A1 = 100 A1+A1 = 120	30	45	180	25
Codice/Code			68614020	68624020	-	68604020					

ESEMPI DI MONTAGGIO - ASSEMBLY EXAMPLES

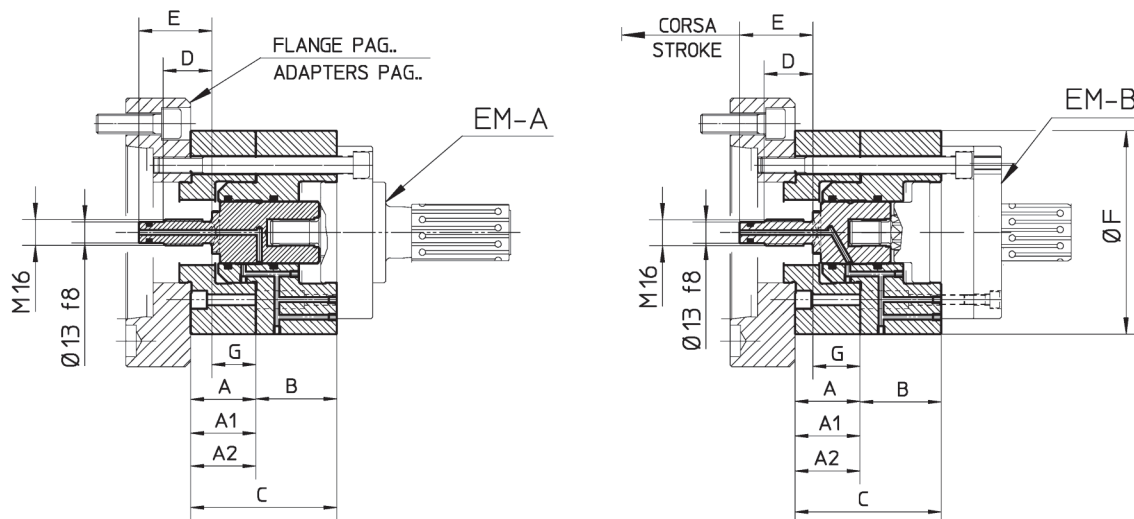

Lista parti di ricambio

Spare parts list

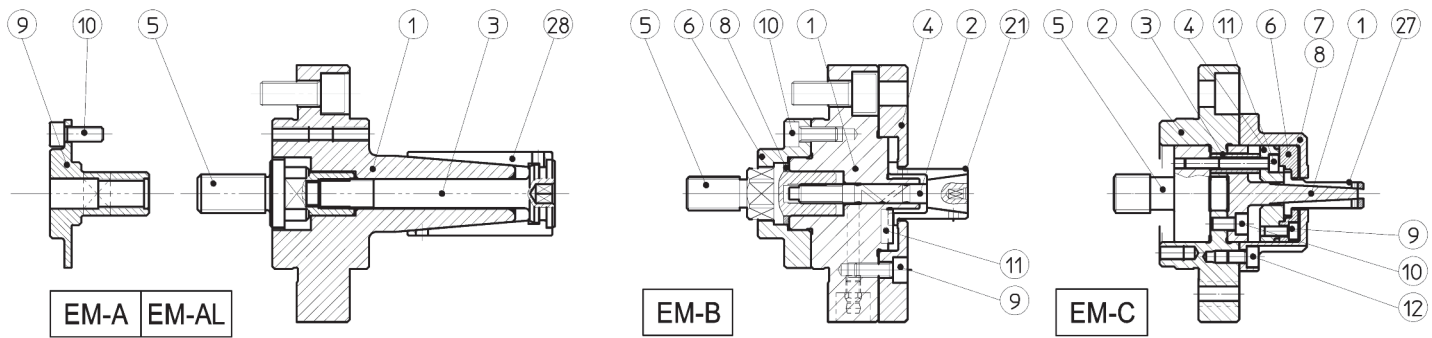

EM-A Grandezza/Size

Part. no.	GR. 1	GR. 2	GR. 3	GR. 4	GR. 5	GR. 6	GR. 7	GR. 8	GR. 9	GR. 10	GR. 11
1	68010110	68010210	68010310	68010410	68010510	68010610	68010710	68010810	68010910	68011010	68011110
3	68030110	68030210	68030310	68030410	68030510	68030610	68030710	68030810	68030910	68031010	68031110
5	68050110	68050210	68050310	68050410	68050510	68050610	68050710	68050710	68050710	68051010	68051110
9	68090110	68090210	68090310	68090410	68090510	68090610	68090710	68090710	68090710	68091010	68091110
10	3-M6x16										
3 - 28	Gruppo pinza - per i ricambi vedi catalogo pag. 86 / Sleeve group - see catalogue page 86 for spares										

EM-AL Grandezza/Size

Part. no.	GR. 1	GR. 2	GR. 3	GR. 4	GR. 5	GR. 6	GR. 7	GR. 8	GR. 9	GR. 10	GR. 11
1	68010111	68010211	68010311	68010411	68010511	68010611	68010711	68010811	68010911	68011011	68011111
3	68030110	68030210	68030310	68030410	68030510	68030610	68030710	68030810	68030910	68031010	68031110
5	68050111	68050211	68050311	68050411	68050511	68050611	68050711	68050811	68050911	68051011	68051111
9	68090111	68090211	68090311	68090411	68090511	68090611	68090711	68090811	68090911	68091011	68091111
10	3-M6x16										
3 - 28	Gruppo pinza - per i ricambi vedi catalogo pag. 86 / Sleeve group - see catalogue page 86 for spares										

EM-B Grandezza/Size

Part. no.	GR. 0	GR. 1	GR. 2	GR. 3	GR. 4
1	68010021	68011021	68012021	68013021	68014021
5	68050021	68051021	68052021	68053021	68054021
6	68060020		68063020		68064020
8	68080020		68082020	68083020	68084020
9		3-M6x16		6-M6x16	6-M8x20
10			6-M6x12		
11		71231137		71231140	68094020 + 71113310
2 - 4 - 21	Per i ricambi del disco, del cono e della pinza - vedi catalogo pag. 89 / For disk, taper and sleeve spares - see catalogue page 89				

EM-C Grandezza/Size

Part. no.	GR. 1.1	GR. 1.2	GR. 2	GR. 3
1	68010130		68010230	68010330
2		68020130		
3		68030130		
4		68040130		
5		68050130		
6	68060130		68060230	68060330
7	68070130	-	68070230	68070330
8	-	68080130	-	-
9		3-M4x10		
10		3-M5x10		
11		3-M4x35		
12		3-M5x8		
27	Per i ricambi delle pinze - vedi catalogo pag. 90 / For sleeves spares - see catalogue page 90			