

05057700 - LT-S VDI40ER25F RF OF50G60MLMZ

| | |
|-----------------------|---|
| Type | LT-S OFS Tool holder straight offset |
| Mounting | VDI 40 |
| Tool output | Collet nut ER 25 F - internal nut |
| Coolant | Internal coolant |
| Offset [mm] | 50 |
| Direction of rotation | r1 ↻ r2 ↻ |
| Max speed [rpm] | 6000 |
| Max torque [Nm] | 63 |
| Ratio | 1:1 |
| H [mm] | 102 |
| Max pressure [bar] | 20 |
| Accessories | N.A. |
| Notes | N.A. |
| Mounting tips | N.A. |

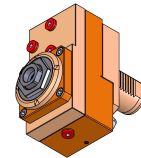

ATTENTION: CHECK THE ORIENTATION OF THE VDI TEETH

Always check live tool dimensions on the turret

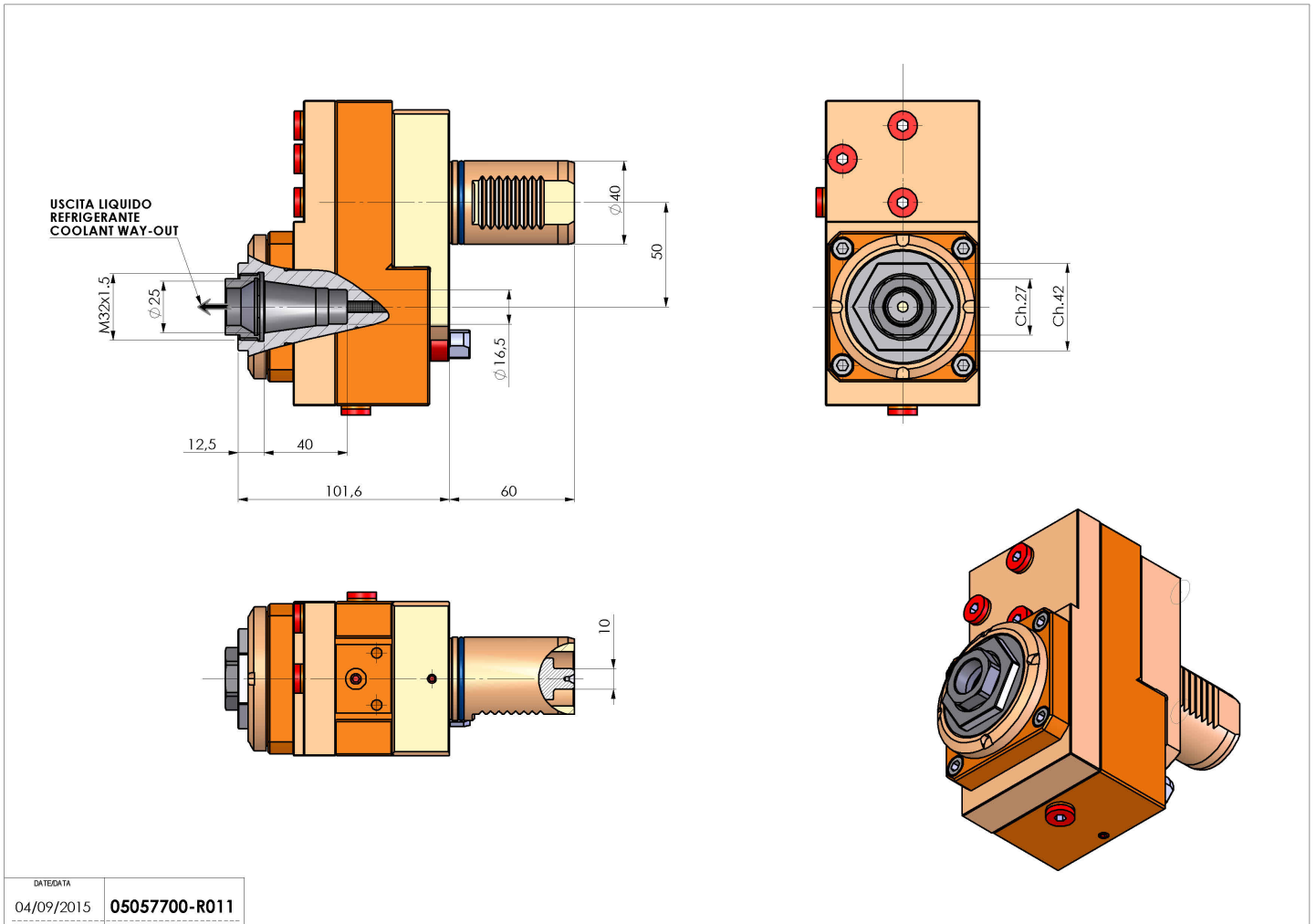

| | |
|-----------|---------------|
| DATE/DATE | 04/09/2015 |
| | 05057700-R011 |

Subject to technical changes