

## 05248600 - LT-A VDI50 ER40 OFS LR HRF H90

|                              |  |
|------------------------------|--|
| <b>Type</b>                  | LT-A OFS<br>Tool holder offset angle 90° |
| <b>Mounting</b>              | VDI 50                                   |
| <b>Tool output</b>           | Collet nut ER 40                         |
| <b>Coolant</b>               | HRF Internal coolant                     |
| <b>Direction of rotation</b> | r1  r2                                   |
| <b>Max speed [rpm]</b>       | 6000                                     |
| <b>Max torque [Nm]</b>       | 50                                       |
| <b>Ratio</b>                 | 1:1                                      |
| <b>H [mm]</b>                | 90                                       |
| <b>H1 [mm]</b>               | 43                                       |
| <b>Max pressure [bar]</b>    | 80                                       |
| <b>Accessories</b>           | N.A.                                     |
| <b>Notes</b>                 | N.A.                                     |
| <b>Mounting tips</b>         | N.A.                                     |

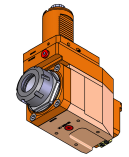

**ATTENTION: CHECK THE ORIENTATION OF THE VDI TEETH**

Always check live tool dimensions on the turret

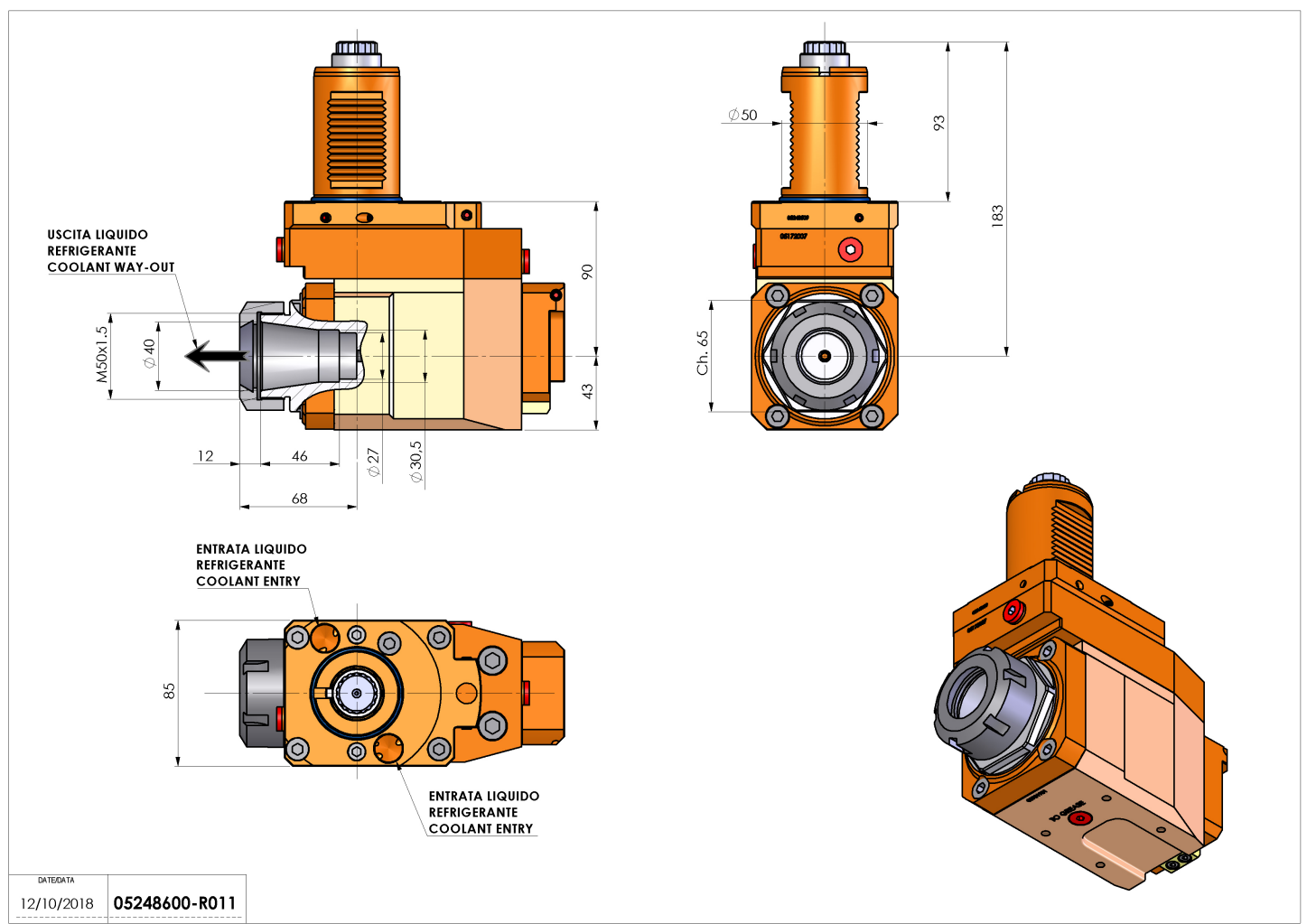

|             |               |
|-------------|---------------|
| DATE/GRA    | 12/10/2018    |
| PART NUMBER | 05248600-R011 |

**Subject to technical changes**