

05019300 - LT-T D44 ER11F H44-100

| | |
|------------------------------|------------------------------|
| Type | LT-T Tool holder tiltable |
| Mounting | CYLINDRICAL SHANK 44 |
| Tool output | Collet nut ER 11 F |
| Coolant | External coolant |
| Direction of rotation | r1 r2 |
| Max speed [rpm] | 6000 |
| Max torque [Nm] | 5 |
| Ratio | 1:1 |
| H [mm] | 44-102 |
| Accessories | N.A. |
| Notes | N.A. |
| Mounting tips | Machining angle limitation |

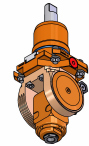

Always check live tool dimensions on the turret

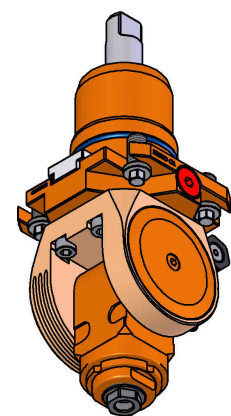
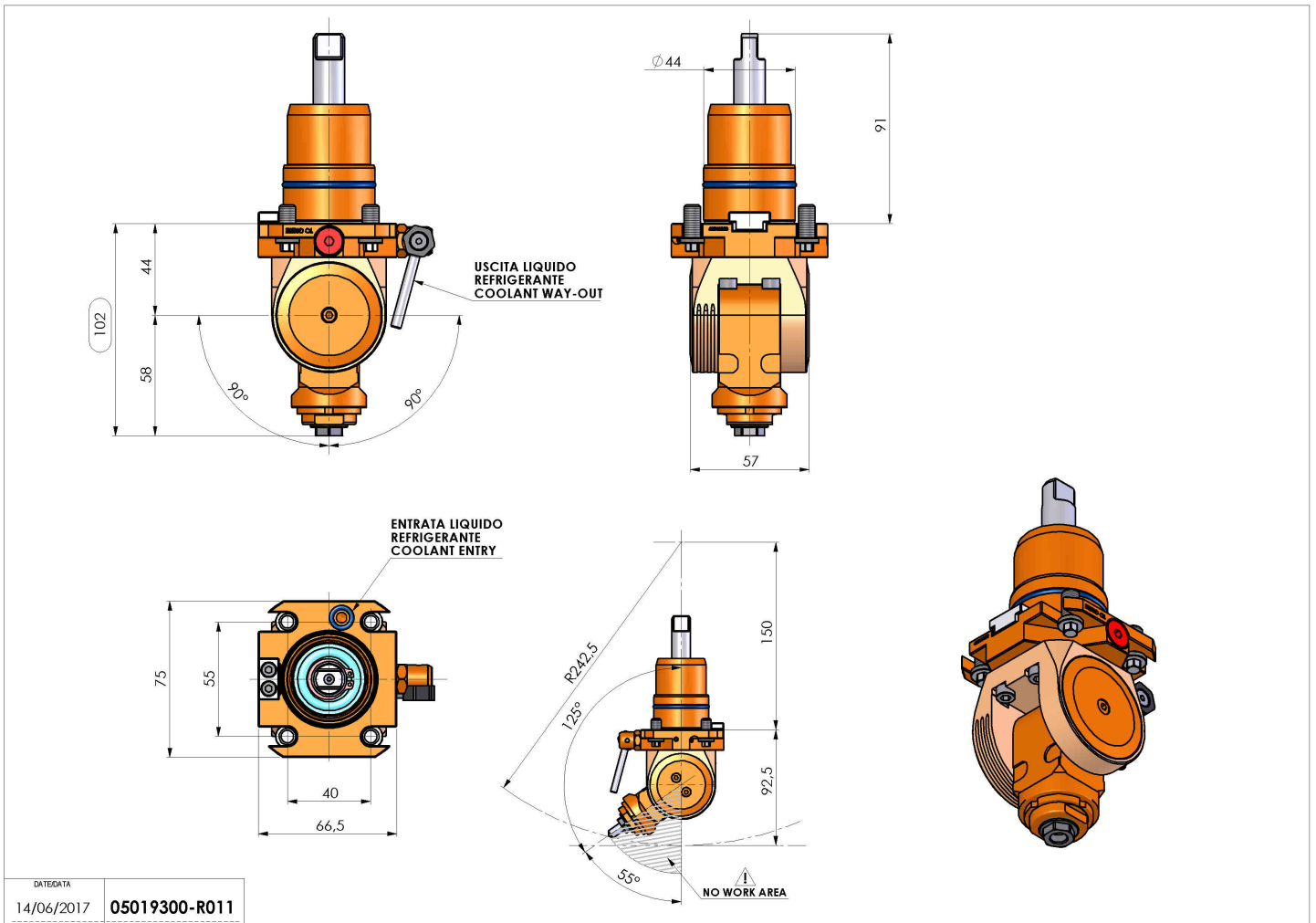

| | |
|------------|----------------------|
| DATE/DATE | |
| 14/06/2017 | 05019300-R011 |

Subject to technical changes